

# Luggage

## Package Tray Trim & Luggage Cover

A package tray trim is available as an option for 3-door models and a luggage cover is available as an option for 5-door models in consideration of exterior appearance.

### Package Tray Trim (3-Door)

- The package tray trim is composed of two boards: a front board and rear board. It is possible to fold it back at the part where the front and rear boards are connected.
- The package tray trim has a structure that makes it easy to remove for more luggage space. When it is removed, it can be stored behind the rear No. 1 seat with a fixing band.
- Folding back the front board of the package tray trim allows the rear No. 1 seat to recline. If the headrest of the rear No. 1 seat is removed, full reclining is possible.

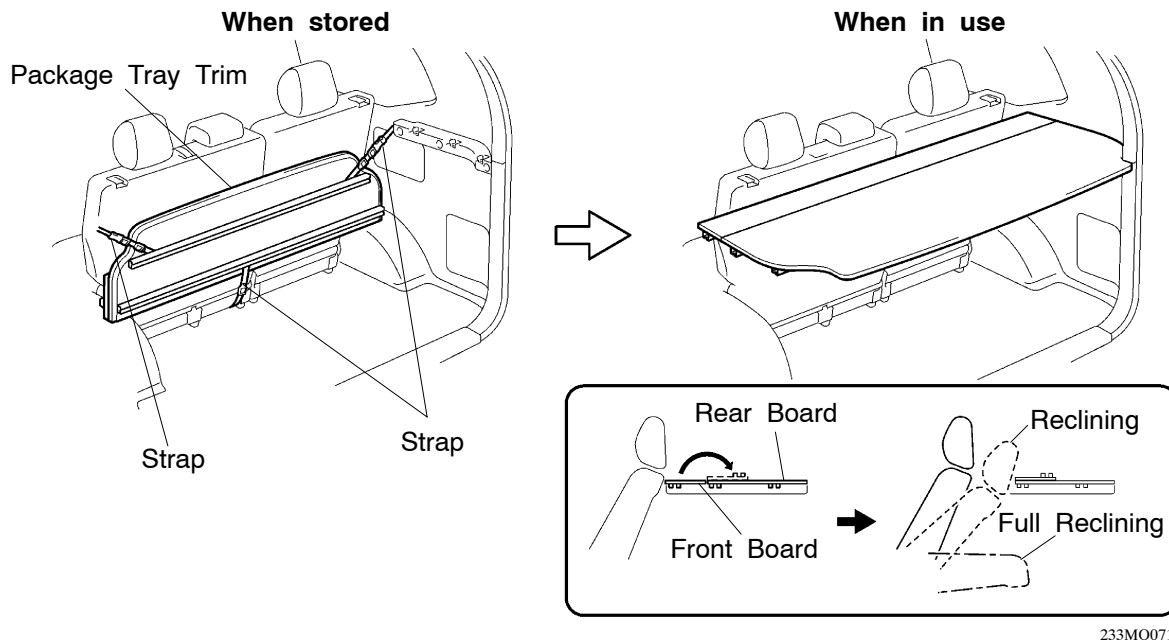

233MO071

### Luggage Cover (5-Door)

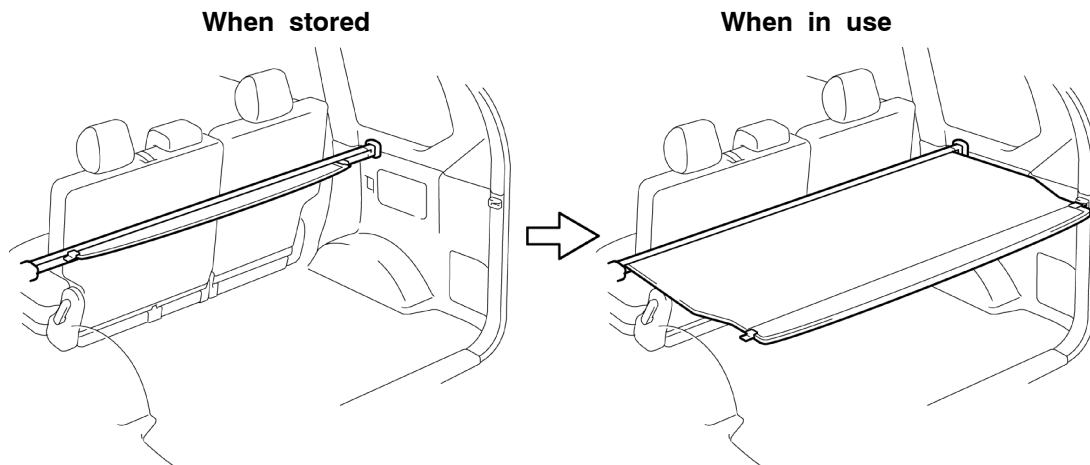

233MO072

## ***Tie-down Hook***

The luggage room has 4 tie-down hooks in consideration of ease of use within the luggage room.

**3-Door**

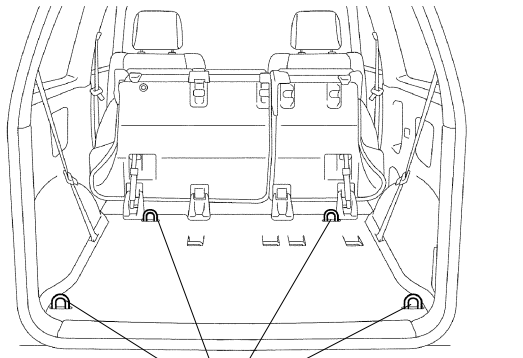

233MO069

Tie-down Hook

**5-Door**

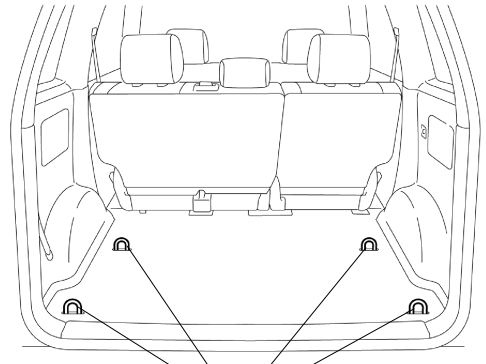

233MO070

Tie-down Hook